

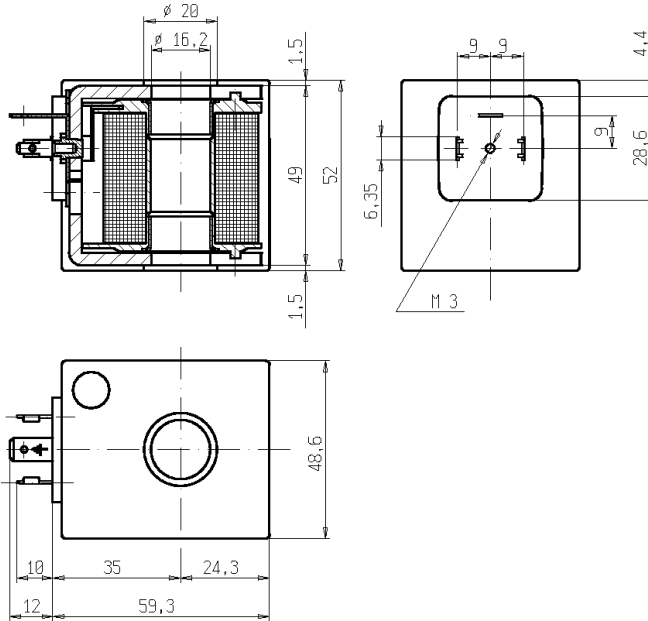

COIL - SPADE TERMINALS - DIN 46340
Series Z923..- Z914A

Z9..

ISO 9001



FEATURES - Rated for continuous duty (ED 100%) in alternate current (AC) or direct current (DC). Vacuum impregnated winding by polyester resin, insulation class and encapsulation material as per table.

AMBIENT TEMPERATURE - As per table.

PROTECTION DEGREE - IP65 , according to EN 60529 standard, if the coil is duly fitted with its plug connector.

ELECTRIC CONNECTIONS - Spade terminals 6,3 x 0,8 (DIN46340), 2 line + 1 earth terminals or 3 poles connector (DIN 43650).

STANDARD VOLTAGES - Alternate current (AC) 24V/50Hz – 110V/50Hz (120V/60Hz) - 230V/50Hz - Direct current (DC) 12-24 V .

TOLERANCE - +10% -15% AC and +10% -5% DC

TYPE	MAIN FEATURES	POWER ABSORPTION			AMBIENT TEMPERATURE	NOTES	WEIGHT (kg)	
		AC (VA)		DC (W)				
		Inrush	Holding					
Z923A	- Class "F" (+155°C) - Wires in class "H" (+180°C) - Glass fibre reinforced PBT (polybutylene-terephthalate) encapsulation (blue colour)	50	27	17	-10°C +60°C	1	0,520	
Z923G		150	46	-				2
Z923E		65	33	21				
Z914A	- Class "H" (+180°C) - Glass fibre reinforced PPS (Polyphenylsulphure) encapsulation (black colour)	50	27	17	-10°C +80°C	-		
Z914G		150	46	-				2

NOTES - Other voltages and frequencies on request.
 1 - SEV-ASE APPROVAL (98.50876.01)
 2 - Discontinuous duty ED 60%.

NB - THE VALIDITY OF REPORTED DATA IS REFERRED TO THE DATE OF ISSUE. POSSIBLE UPDATING ARE AVAILABLE ON REQUEST